



# Installation Manual

# G-LIFE

---

INSTALLATION ASSISTANCE ☎ +66 62-628-8668

[www.glifecleanrooms.com](http://www.glifecleanrooms.com)



## **WARNING**

**PLEASE READ BEFORE STARTING INSTALLATION**



**Install the air purifier in areas where it will not be exposed to sunlight and rain.**



**Steps 6–7 involve electrical wiring to the device. If you do not have knowledge or experience in electrical circuit connections, for safety reasons, please hire an experienced electrician to perform the following steps.**



**For safety, install a ground wire. If there is no ground wire, install an additional grounding rod (instructions are at the end of the manual).**

# MAIN COMPONENTS

**Air Purifier Unit**

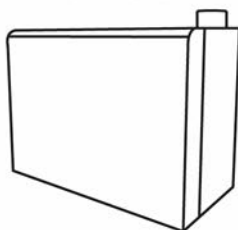

x 1

**Wall-mounting plate for hanging the air purifier**

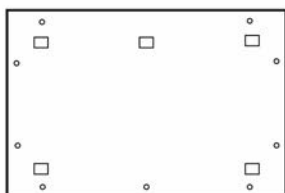

x 1

**2-inch Screws & Plastic Plugs**

For wall-mounting plate



x 10



x 10

**Air Grille Controller**

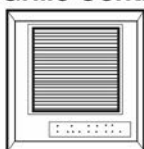

x 1

**1.5-inch Screws + Plastic Plugs**

For Air Grille Mounting Plate



x 4



x 4

**Black Mounting Plate For the Air Grille**



x 1

**Remote Control With Battery**



x 1

**Extension Control Cable**



x 1

**Connector for Extension Control Cable**



x 1

**Air Duct**

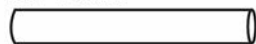

x 1

**Air Duct Elbow 90°**



x 1

**ULPA Filter**

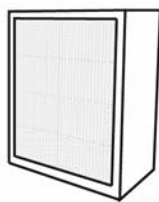

x 1

**Activated Carbon Filter Set**



x 1

**Germicide Filter**



x 1

**Pre-filter**



x 1

**Air Filters Locking Plate**

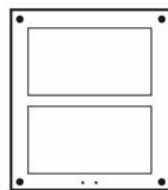

x 1



Install the air purifier in areas where it will not be exposed to sunlight and rain.

**INSIDE**

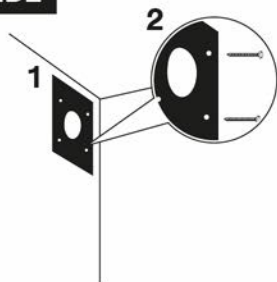

**1**

## DRILL A HOLE

Drill a hole (3½ inches in diameter) on the wall to install the air duct.

**2**

## INSTALL BLACK MOUNTING PLATE

Install the black mounting plate on the inside wall by inserting the duct-end into the drilled hole.

**OUTSIDE**

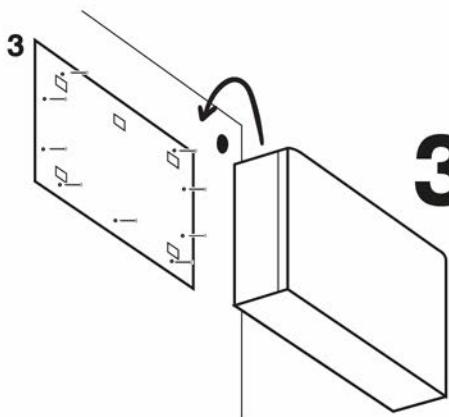

**3**

## INSTALL AIR PURIFIER

On outside wall, install the mounting plate for hanging the air purifier and then hang the air purifier unit on it.

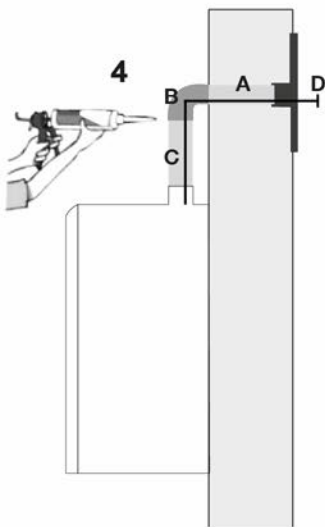

# 4

## INSTALL AIR DUCT

- (A) Cut the first section of the air duct equal to the thickness of the wall and connect it to the black mounting plate. Seal the joint with silicone sealant.
- (B) Connect the other end of the air duct to the 90° connector elbow and apply silicone sealant to the joints.
- (C) Cut the second section of the air duct and connect it with the 90° connector elbow and the air purifier unit. Seal the joint with silicone sealant.
- (D) Route the control cable from the air purifier through the air duct and the black mounting plate inside the house (use the Extension Control Cable and the Connector if required).

In this step, seal all joints and seams with silicone sealant to prevent air and water leaks.

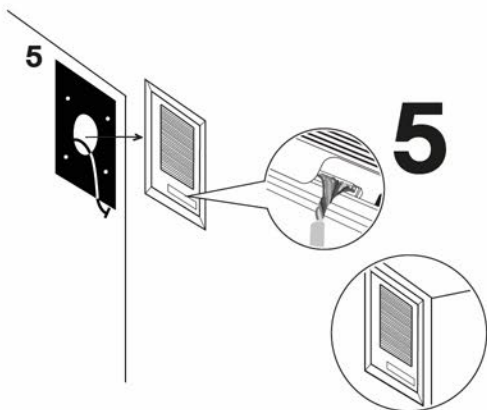

# 5

## INSTALL AIR GRILLE

Connect the control cable to the control panel behind the air grille controller and install the air grille on the black mounting plate installed in step 1.



Steps 6-7 involve electrical wiring to the device. If you do not have knowledge or experience in electrical circuit connections, for safety reasons, please hire an experienced electrician to perform the following steps.



### Warning!

Always switch-off the breaker before conducting the wiring procedures.

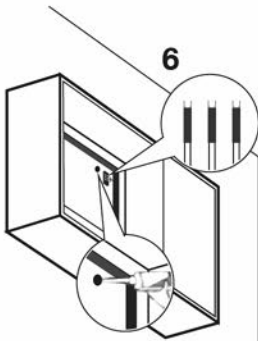

## 6

### ELECTRICAL WIRING

Open the air purifier cover and route the power cables into the terminal block according to the labelled sticker. Ensure the cables are securely passed through the black rubber grommet and sealed with silicone to prevent air and water leaks.

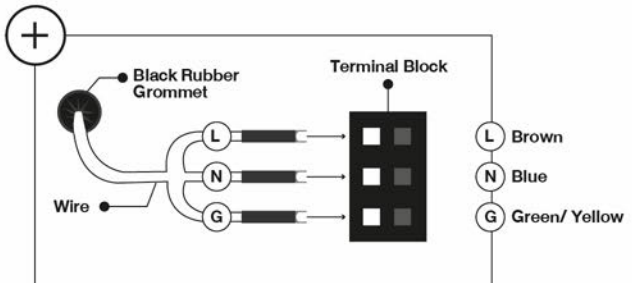

### Warning!

Always switch-off the breaker before conducting the wiring procedures.

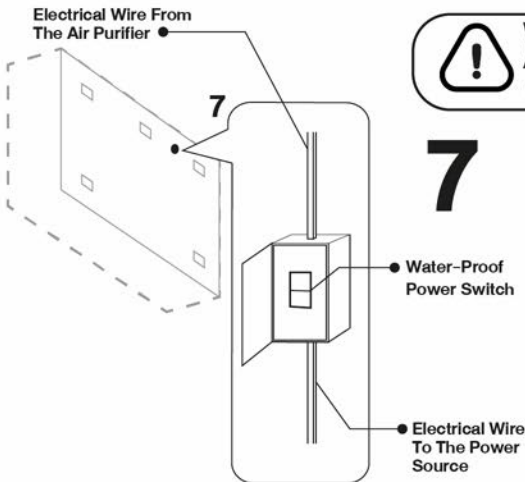

## 7

### CONNECT TO POWER SOURCE & GROUND WIRE

Install a power switch for safety during maintenance and filter replacement. Connect the power cables to the nearest electrical supply.



For safety, install a ground wire. If there is no ground wire, install an additional grounding rod (instructions are at the end of the manual).

## 8 INSTALL FILTERS

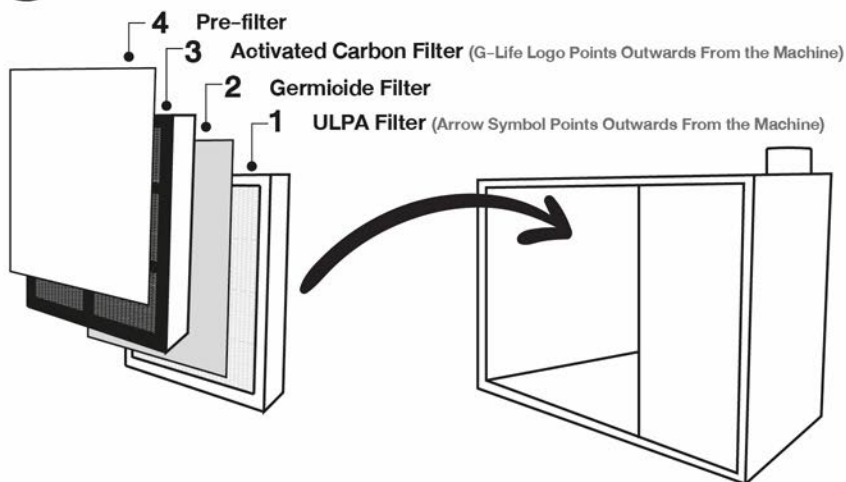

## 9 FINISH INSTALLATION

Lock the filters in place with the locking plate and close the air purifier cover.

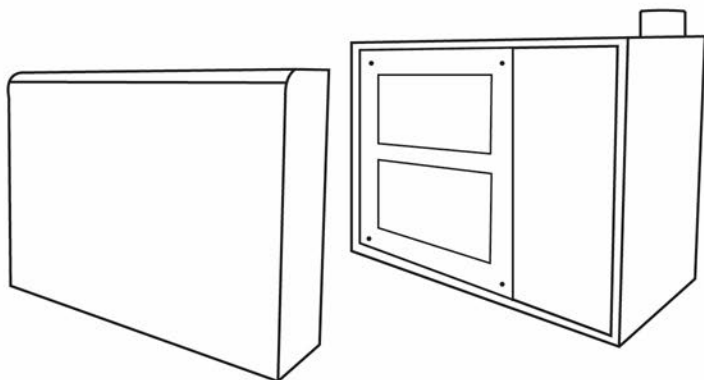



# HOW TO INSTALL GROUNDING RODS

## EQUIPMENT



**GROUNDING ROD CLAMP**



**STANDARD GROUNDING ROD**

Length: No less than 2.4 meters.  
Diameter: No less than 16 millimeters (5/8 inch).

## INSTALLATION STEPS

The grounding rod should be driven into the ground at least 0.6 meters away from the building. The rod should be buried at least 0.3 meters deep (or 0.75 meters if installed horizontally).

For a grounding rod to meet the standards, the soil resistance must not exceed 5 ohms. If the installed grounding rod has a resistance greater than 5 ohms, an additional rod should be driven parallel to the first one, with a minimum distance of 2.4 meters between them, as shown in the illustration.

### VERTICAL DRIVE

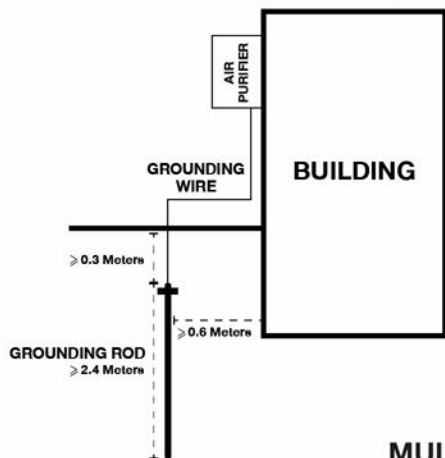

### HORIZONTAL DRIVE

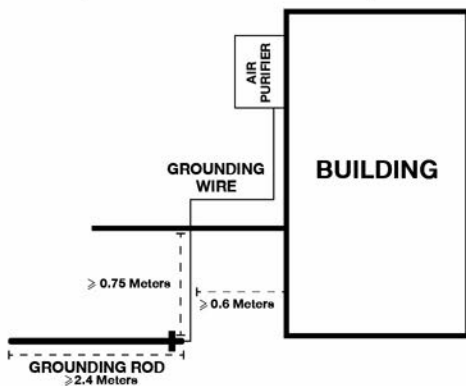

### MULTIPLE-ROD DRIVE

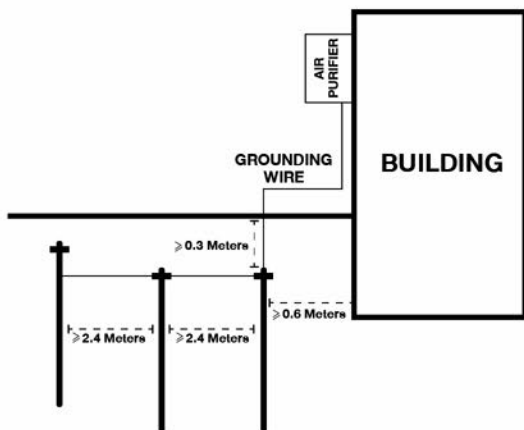

### EARTH PIT BOX

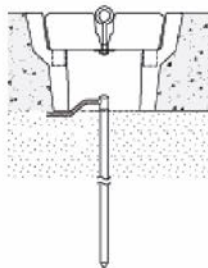

To prevent damage to the connection points and make maintenance easier, you can use a ready-made earth pit box to cover the junction point.



